

HRH1827BL

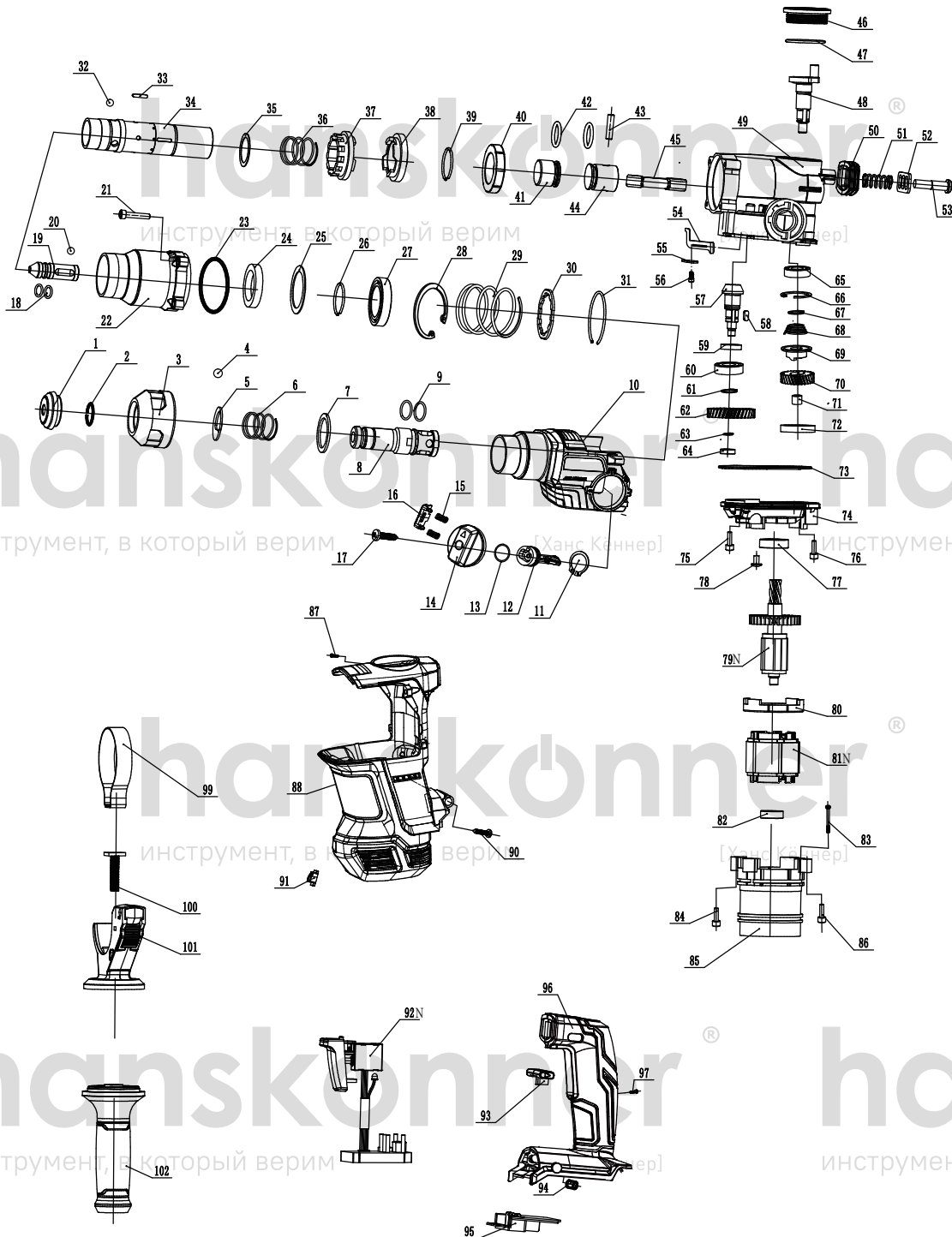

NO.	DESCRIPTION	NO.	DESCRIPTION
1	RUBBER COVER	51	SHOCK ABSORPTION SPRING
2	STEEL WIRE BLOCK RING $\Phi 18 \times 2$	52	SPRING RACK
3	FLEX SHEATH	53	SHOCK ABSORPTION SCREW
4	STEEL BALL $\Phi 7.5$	54	SHIFT FORK
5	GUIDE WASHERS	55	SHIFT FORK RACK
6	FLEX SHEATH RING	56	HEX.SOCKET BOLT SET M4 \times 12
7	FLEX SHEATH GASKET	57	SMALL GEAR
8	ROTATING SLEEVE	58	PALT KEY 3 \times 3 \times 8
9	O RING $\Phi 20.9 \times 2.1$	59	DISTANCE RING
10	FRONT SHELL COVER	60	BALL BEARING 6902
11	RETAINING RING $\Phi 20$	61	STEEL WIRE BLOCK RING $\Phi 15$
12	FUNCTION LEVER	62	FLAT GEAR
13	O RING $\Phi 18 \times 1.5$	63	STEEL WIRE BLOCK RING $\Phi 12$
14	FUNCTION KNOB	64	BALL BEARING 627
15	PUSHBUTTON SPRING	65	BALL BEARING 6002
16	PUSHBUTTON SPRING	66	STEEL WIRE BLOCK RING $\Phi 32$
17	TAPPING SCREWS ST4 \times 18	67	STEEL WIRE BLOCK RING $\Phi 15$
18	O RING $\Phi 11 \times 1.9$	68	CRANK SHAFT CLUTCH SPRING
19	RAM	69	CRANK SHAFT CLUTCH
20	STEEL BALL S $\Phi 7.14$	70	CRANKSHAFT GEAR
21	HEX.SOCKET BOLT SET M5 \times 22	71	CYLINDER LINER
22	FRONT SHELL	72	SUPPORTING LINER
23	ORING	73	SEAL RING FOR INNER COVER
24	OIL SEAL RING	74	INNER COVER
25	WASHER 906	75	PHILLIPS PAN HEAD SCREWS 5X22
26	STEEL WIRE BLOCK RING $\Phi 28 \times 1.6$	76	PHILLIPS PAN HEAD SCREWS 5X25
27	BALL BEARING 906	77	BALL BEARING 6001
28	RETAINING RING $\Phi 47$	78	PHILLIPS SCREWS 5X12
29	FIXING SPRING	79N	ARMATURE
30	FIXING GASKET	80	FAN GUIDE
31	RETAINING RING $\Phi 55 \times 1.5$	81N	STATOR
32	STEEL BALL $\Phi 6.35$	82	BALL BEARING 608
33	PALT KEY 3 \times 3 \times 14	83	TAPPING SCREWS ST2.7 \times 40
34	CYLINDER	84	HEX.SOCKET BOLT M5 \times 25
35	WASHER	85	STATOR ASS'Y
36	CYLINDER SPRING	86	HEX.SOCKET BOLT M5 \times 40
37	CYLINDER SAFETY CLUTCH	87	TAPPING SCREWS ST4 \times 16
38	BIG GEAR	88	HOUSING
39	STEEL WIRE BLOCK RING $\Phi 28 \times 1.6$	90	TAPPING SCREWS ST4 \times 22
40	OILINESS BEARING	91	LIGHT INDICATOR
41	IMPACT PISTON	92N	SWITCH CONTROLLER COMPONENT
42	O RING $\Phi 19 \times 3.1$	93	FORWARDER/ REVERSE KNOB
43	PISTON PIN	94	POLE
44	PLASTIC PISTON	95	CONTACT PIECE BRACKET
45	PLASTIC CONNECTING ROD	96	HANDLE
46	OIL COVER	97	TAPPING SCREWS ST4 \times 16
47	O RING $\Phi 34 \times 2.65$	99	FIXING BELT
48	CRANK SHAFT	100	FIXING SCREW M8 \times 50
49	GEAR BOX	101	SIDE HANDLE ASS'Y STEEL TIE
50	SHOCK ABSORPTION JACKET	102	SIDLE HANDLE